

# GENERAL INFORMATION

Unless otherwise noted, all events are scheduled in the Hynes Convention Center.

## Registration Hours

Saturday (August 5) ..... 7:00 am to 9:00 pm  
Sunday (August 6) ..... 7:00 am to 6:00 pm  
Monday (August 7) ..... 8:00 am to 4:30 pm  
Tuesday (August 8) ..... 8:00 am to 4:00 pm  
Wednesday (August 9) ..... 8:00 am to 12:00 pm

## ASPB Membership Services & Information

ASPB staff will be available to answer questions about membership. A Membership Booth will be available in the Exhibit area.

## Badge Barcodes

New this year, our badges have 2D barcodes. The barcodes are on your badges to allow exhibitors to scan your badge to contact you after the meeting if you'd like them to. The barcodes contain your name, institution, email, and phone number. The barcodes contain no additional information and require full scanning to gather the information on them. Attendees are welcome to not allow exhibitors to scan their badges if they so choose. Exhibitors will be receiving a post-meeting mailing list that does not contain emails or phone numbers after the meeting. ASPB will honor any attendee who wishes to not be placed on the mailing list. Stop by the Registration Desk for questions.

## Job Placement Center

The Job Placement Center posting area is located near the Registration Desk. Placement notices will be available for viewing during the conference. Placement Center procedures will be the same as in prior years; information sheets will be available to employers and candidates at the Registration Desk.

## Housing

Any questions or problems concerning housing will be handled by ASPB's housing agency, Hachero-Hill, which will have a representative on site near Registration.

## Exhibits & Posters

Exhibits are open during scheduled exhibit hours. Posters can be viewed in the Exhibit Hall on most days until 11:00 pm. For security reasons, the hall will close at 11:00 pm. Please make time in your schedule to visit exhibitors and posters of interest to you. Exclusive poster and exhibit sessions will be held Sunday, 5:10 - 7:10 pm (All even-number abstracts - 5:10 - 6:10 pm; all odd-number abstracts - 6:10 - 7:10 pm) and Monday 8:30 - 11:00 pm. (All odd-number abstracts - 9:00 - 10:00 pm; all even-number abstracts - 10:00 - 11:00 pm). Please attend your posters during the time slots.

## Speaker Ready Room

Room 307 will be available for PowerPoint presentation testing. Speakers should test their presentations at least an hour prior to their presentation and be at their sessions at least 10 minutes before.

## Message Board

Plant Biology 2006 will provide the traditional message boards near the Registration Desk for attendees to send and receive messages. An online message board is also available on the ASPB website this year. Do not use the Job Placement Center boards for messages.

## Internet E-mail Café & Wireless Access

Plant Biology 2006 will feature an Internet Café in the Exhibit Hall. It will be open the same hours as the posters. Please limit your online time to 10 minutes or less if others are waiting. Complimentary wireless internet access is available throughout the Hynes Center for attendees.

## Getting Around Boston

Information on Boston attractions will be available at your hotel concierge and a restaurant desk will be available in the Hynes Center. You will find that all the hotels in which we've reserved space for this year's meeting attendees are within a two- to seven minute walk of the Convention Center.

## Getting to the Hynes Center

**Subway:** The Hynes Convention Center is located on the Green Line (B,C, or D trains) at the Hynes Convention Center/ICA stop. The fare for the subway is \$1.25. Once you get off the subway, choose any exit and follow the signs to the Hynes. The Hynes entrance is 1 block east on Boylston Street from the Boylston Street Exit or two blocks from the Massachusetts Avenue Exit. If you are traveling on the Green line E, the closest stop is Prudential. Here, you can enter the Hynes via the Shops at Prudential. Use any entrance and follow the signs to the Hynes.

**Amtrak/Commuter Rail:** From points west or south of Boston, get off at the Back Bay Station and walk through the Copley Place Mall to the Prudential Center and follow the signs for the Hynes Convention Center

## Getting to Logan Airport

**Taxi:** Journey time from downtown Boston is approximately 30 minutes, depending on traffic. Taxi fare is about \$30 USD

**Bus/Van Shuttle:** A number of companies run services to and from the airport (some offer student discounts), including:

**Back Bay Coach** operates a shared van service from the airport to many Boston hotels. (617) 746-9909

**City Transportation** operates from Boston hotels. (617) 561-9000

**Logan/Boston Hotel Shuttle** has services from many downtown hotels to Logan. Reservations: (877) 315-4700

**JC Transportation**, at (800) 517-2281, offers group rates from Logan International Airport. A shuttle leaves every 20 minutes from every terminal to the Boston Hotels, which include the Hilton Back Bay and the Boston Marriott. They also offer student discounts (call for current rates)

## Famous "T" (Subway System):

You can also travel from the airport via Boston's subway for about \$1.25 USD each way. For planning your subway travel visit: <http://www.mbta.com/>

## Parking

Within a three-block walk of the Hynes Convention Center are numerous parking garages totaling over 4,400 spaces. There is limited meter parking available around the Hynes and adjacent streets.

## Safety Notice

While enjoying the beautiful city of Boston, please remember to keep your personal belongings secured. Traveling in groups is a safe way to visit the many attractions of Boston.

## Meeting Survey

A meeting survey will be e-mailed to attendees immediately following the meeting. Your response is considered valuable by the Program Committee. Thank you for your cooperation.

## Plant Biology 2006 Smoking Policy

Smoking is not allowed at any Plant Biology 2006 annual meeting functions or areas.

## Child Care

ASPB will provide up to a **\$200 subsidy PER child, PER family** for child care or babysitting services at Plant Biology 2006 for parents who would otherwise be unable to attend sessions and will not have a non-attending spouse present. Parents should make their own arrangements via their hotel concierge, and then provide receipts to the Plant Biology 2006 registration desk at the meeting or by fax to 301-251-6740. No claims will be honored if received more than 60 days after the meeting closes. Reimbursements will be processed at ASPB headquarters immediately following the meeting. ASPB assumes no responsibility with respect to child care services and accepts no liabilities relative to the services.

# John B. Hynes Veterans Memorial Convention Center Second Level

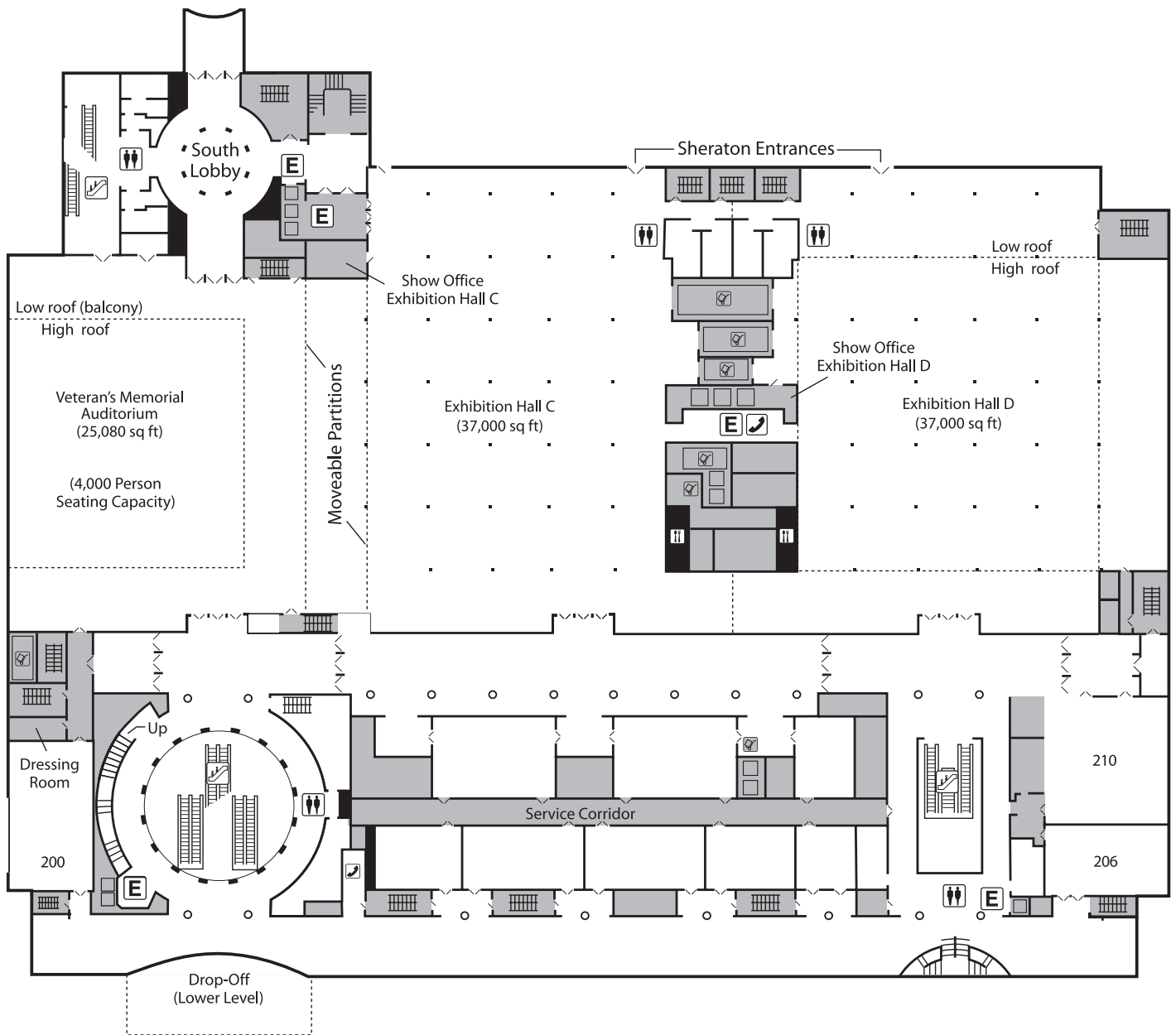

# John B. Hynes Veterans Memorial Convention Center

# Third Level

